

# MyHOME FLATWALL



Aesthetic value and  
functional integration  
for home automation



# MyHOME FLATWALL

## Index

2-13	
General features	<ul style="list-style-type: none"> <li>MyHOME FLATWALL 240 - 270 2</li> <li>MyHOME FLATWALL 150 4</li> <li>MyHOME FLATWALL for all basic or advanced system needs 6</li> <li>Aesthetic and functional value with minimum space requirements 8</li> <li>Composition of MyHOME FLATWALL 240 - 270 switchboard 10</li> <li>Composition of MyHOME FLATWALL 150 switchboard 12</li> </ul>
14-33	
General rules for installation	<ul style="list-style-type: none"> <li>Installation heights for every need 14</li> <li>The device-holder supports 15</li> <li>Installation solutions 16</li> <li>MyHOME FLATWALL 240 - 270</li> <li>Assembly guide: switchboard solution 18</li> <li>MyHOME FLATWALL 150</li> <li>Assembly guide: switchboard solution 20</li> <li>MyHOME FLATWALL 240 - 270</li> <li>Assembly guide: electric distribution board solution 22</li> <li>MyHOME FLATWALL 150</li> <li>Assembly guide: electric distribution board solution 24</li> <li>MyHOME FLATWALL 240 - 270</li> <li>Assembly guide: floor riser solution 26</li> <li>Examples of composition 30</li> <li>Examples of aesthetic compositions 31</li> <li>How to install MyHOME FLATWALL 32</li> </ul>
34-39	
Catalogue	MyHOME FLATWALL
40	
Design customisation	



# MyHOME FLATWALL 240-270



**The innovative design** solution for home automation and electric systems in residential buildings.

**Non invasive and with a high aesthetic value,** it provides a centralised and rational installation of all electric, home automation and traditional services.



# MyHOME FLATWALL 150



**MyHOME FLATWALL 150** in the switchboard version for the management of small apartments.

**Ideal for small apartments**, it is the installation solution for home automation systems with basic functions.

# MyHOME FLATWALL

for all basic or  
advanced system needs

## EXAMPLE OF FLATWALL H150 INSTALLATION:

small households or home automation  
systems with basic functions.



1

MyHOME FLATWALL 150  
Switchboard type solution

### 1 Switchboard type solution

Configuration providing interaction with the MyHOME system through room control (Touch Screen), video handset (Video Display) and burglar-alarm central unit. It also enables intervention on the earth leakage and thermal magnetic electrical safety and protection devices inside the corresponding switchboard.

### 2 Electric distribution board type solution

Configuration ensuring the containment of all DIN actuators and power supplies of the MyHOME system, making them easily accessible.

### 3 Floor riser type solution

Building floor crossing configuration, for distribution using common service cables (only possible with FLATWALL 240-270).



2

Electric distribution board type solution



## EXAMPLE OF FLATWALL 240 - 270 INSTALLATION

all these solution can be fully integrated with the room design thanks to the finishing panels, supplied in white, and which can be painted using standard masonry paints.

**1**

MyHOME FLATWALL 240 - 270  
Switchboard type solution

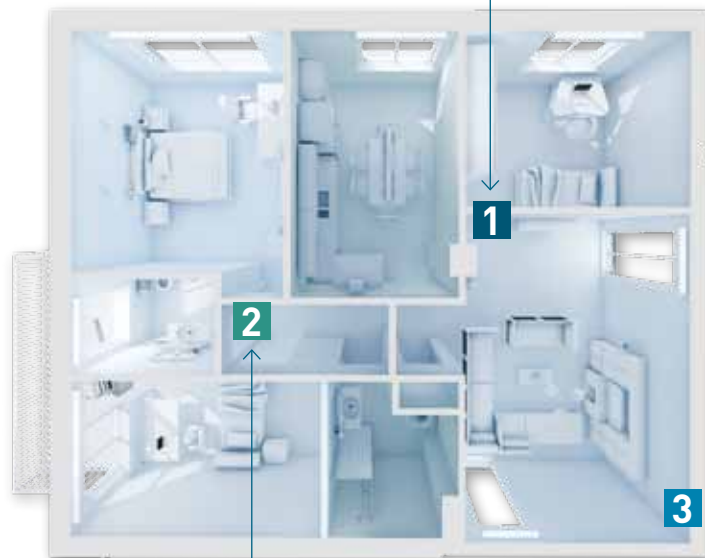
**1****2****3****2**

Electric distribution board type solution

**3**

Floor riser type solution



MyHOME FLATWALL 240 - 270

MyHOME FLATWALL features a sophisticated design and extreme functionality of all its components. The accessibility to the installed devices depends on their use:

- some sections are only accessible to the installer, to perform the required maintenance operations on the installed devices

- other sections are accessible to the end user for interaction with the system.

Thanks to the protrusion from the wall, 2 cm only, the paintable front cover panels, and the side surround plates in anodised aluminium, MyHOME FLATWALL provides maximum integration with the residential environment.

#### MyHOME FLATWALL 240-270

Available in the switchboard, distribution panel, and floor riser version, it offers management of the distribution for all electric services inside modern houses. It can be installed in both masonry walls (supporting and partition walls) and in plasterboard walls.

#### MyHOME FLATWALL 150

MyHOME FLATWALL 150 is the ideal solution for containing together all the devices required for a basic home automation system (up to 180 DIN modules) with minimum space requirement. The aesthetic and functional features of the new version are similar to the well-known Flatwall 240-270 version. Most of the complements and accessories used are the same for the two versions, with the exception of the cable entry in the bottom section, which does not require a conduit securing place, therefore allowing more space for housing devices. Installation is possible in both masonry and plasterboard walls.



MyHOME FLATWALL 150

aesthetic and  
**FUNCTIONAL** value with

New in the FLATWALL range, is a box for the installation of multimedia devices (router, modem, etc.) used in

Home network systems, promoted by all main telephone providers.

The new FLATWALL accessory creates a dedicated area for multimedia devices. This results in a further concentration of electric

devices, and the disappearance from around the home of the unsightly cables needed for connecting these kinds of devices. BTicino offers its own range of Home network devices, and the FLATWALL multimedia box is one of its integral parts.



Dedicated box for the installation of multimedia devices like ADSL modems or routers. The installation requires a 36 DIN module support (3787).

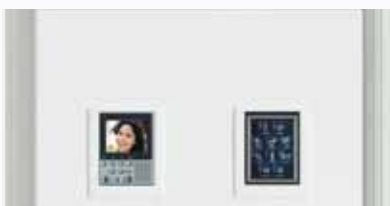

Devices for interaction with the MyHOME system that can be operated by the end user (Touch Screen, burglar alarm central unit, Video Display).



Switchboard for electrical safety and protection devices accessible to the end user. Available in three versions (glass, metal and plastic), featuring installation reversibility. The hinged side can in fact be attached to the right or the left, so that the door can be opened from the most suitable and functional side



Zone accessed by the installer only, housing power supply risers, actuators and other DIN devices (up to 288 modules), for the operation of the MyHOME system. The installation is completed by the white front cover panels.

# minimum SPACE REQUIREMENTS

# Composition of MyHOME FLATWALL 240 - 270

MyHOME FLATWALL consists of:

## 1 One telescopic base module

adjustable on two heights: 270 and 240 cm, which constitutes the metal back to be fitted in the wall; the adjustable feet provide better positioning of the back.

## 2 A series of modular device-holder supports

for the installation of all types of DIN electric devices, with plastic trunkings fitted on the sides, for easy passage and securing of wiring cables. The supports can also accept appropriate brackets for the installation of MyHOME devices.

### 1 INSTALLATION OF BASE MODULE

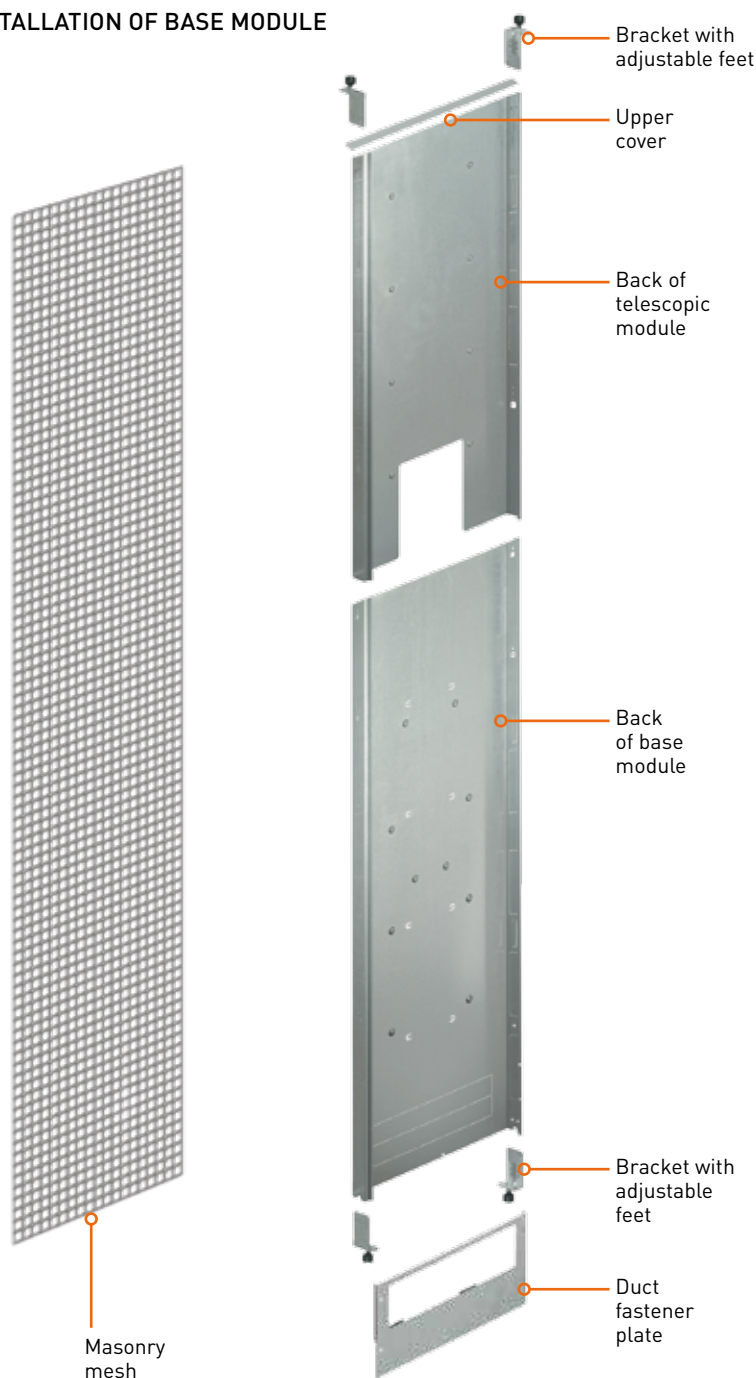

### 2 INSTALLATION OF DEVICE-HOLDER SUPPORTS

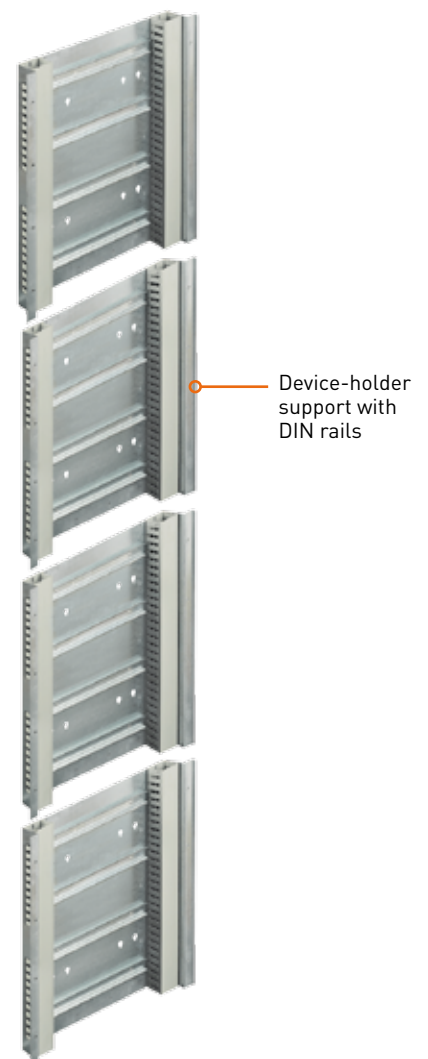

# switchboard

## 3 Front cover panels and surround plates

meeting design and functional requirements. The panels are available with a white finish (RAL 9003). To meet the design requirements of the user they can be painted with standard masonry paints.



## 3 INSTALLATION OF FINISHING ELEMENTS

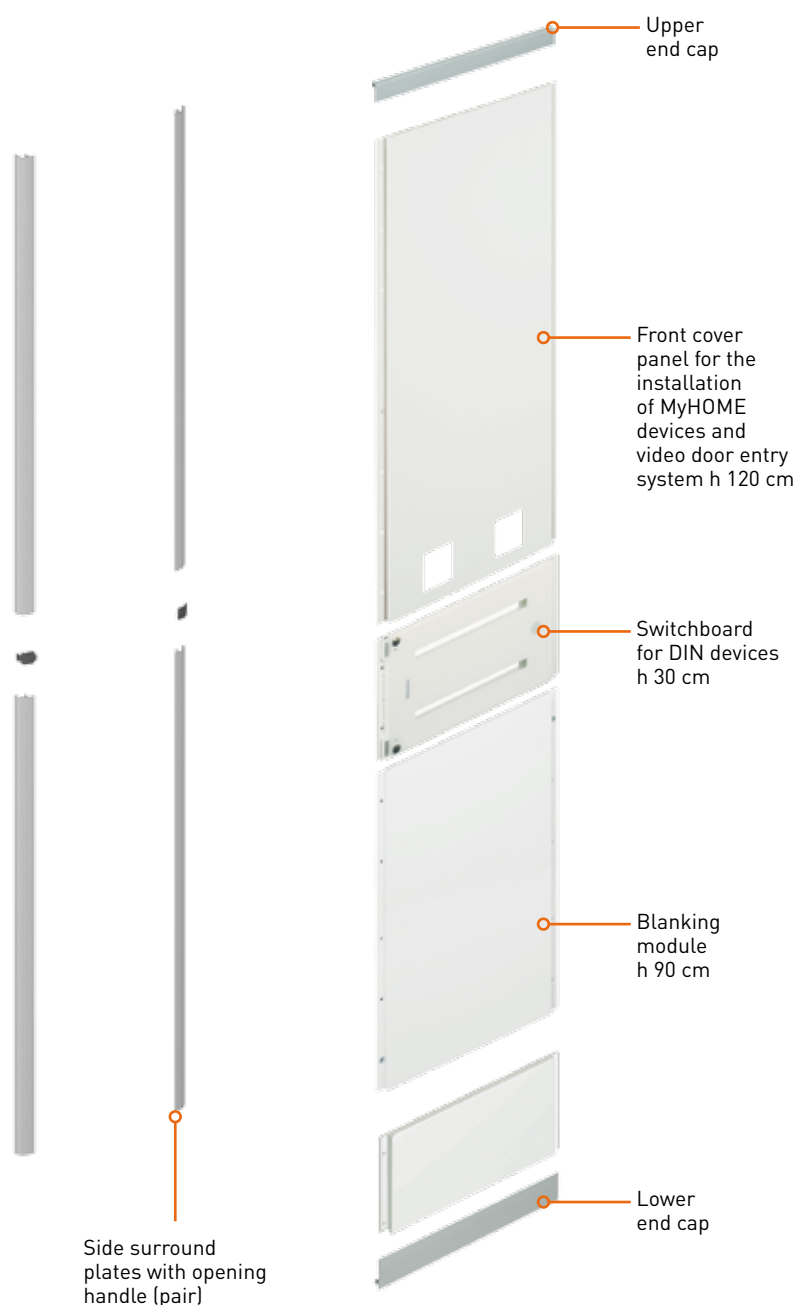

# Composition of MyHOME FLATWALL 150 switchboard

MyHOME FLATWALL consists of:

## 1 A basic module

metal, 150 cm high, flush mounted inside masonry and plasterboard walls. Differently from FLATWALL 240 – 270, there is no conduit securing plate.

In case of need, remove the first DIN guide in the bottom section, to make cable entry easier.

## 2 A series of modular device-holder supports

for the installation of all types of DIN electric devices, with plastic trunkings fitted on the sides, for easy passage and securing of cables. The supports can also accept appropriate brackets for the installation of MyHOME devices, and specific accessories such as the multimedia box dedicated to the installation of modems, routers, etc.

### 1 INSTALLATION OF BASE MODULE

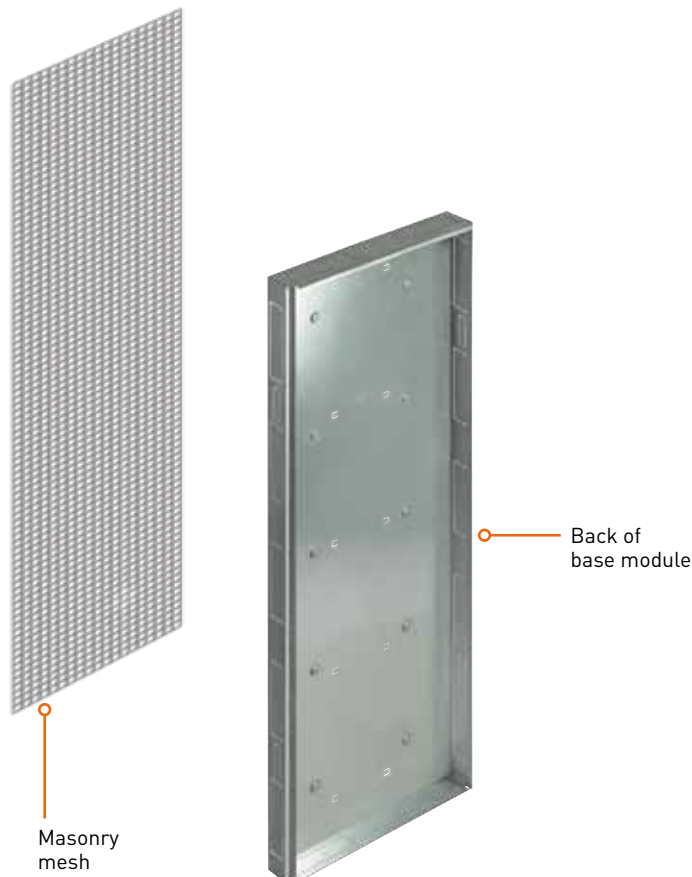

### 2 INSTALLATION OF DEVICE-HOLDER SUPPORTS

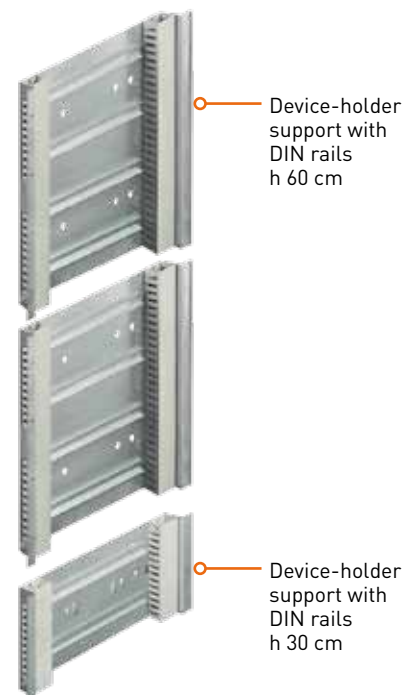

### 3 Front cover panels and surround plates

meeting design and functional requirements. The panels are available with a white finish (RAL 9003). To meet the design requirements of the user they can be painted with standard masonry paints.

### 3 INSTALLATION OF FINISHING ELEMENTS

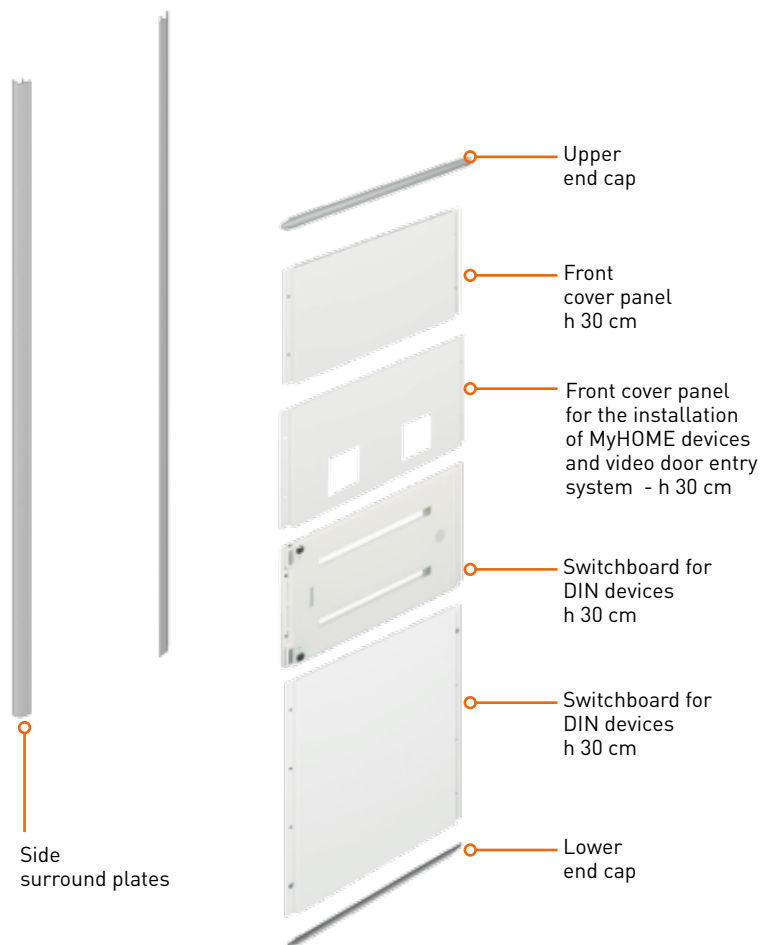

# Installation HEIGHTS for every need

## 150 cm FLUSH MOUNTED BACK

The FLATWALL 150 solution, specifically designed for small households, gives the possibility of installing up to 180 DIN modules (a capacity higher than the average number of devices used in a basic home automation system).

MAX 180 DIN MODULES



## ADJUSTABLE FLUSH MOUNTED BACK, 240 OR 270 cm

Thanks to its exclusive sliding hooking adjustment system, FLATWALL 240-270 makes it possible to adjust on site the height of the column based on the height of the room.

It can be used for installing up to 288 DIN modules (capacity normally higher than the number of devices used in a whole home automation system), centralising all the devices within one single location of the home. By using the appropriate accessory, it is possible to use MyHOME FLATWALL as riser for apartment complex services, or inside apartments and villas on several floors.

MAX 288 DIN MODULES



MAX 252 DIN MODULES

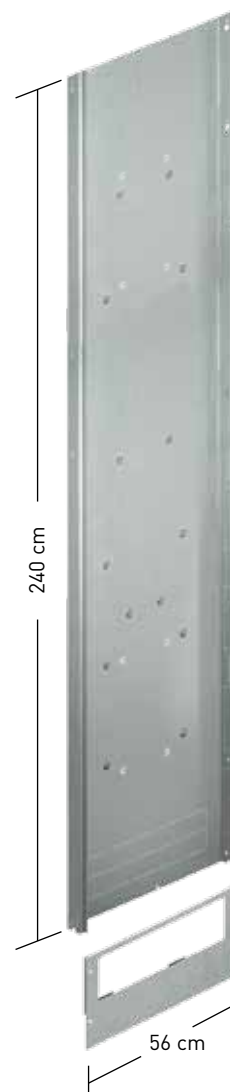



Three types of device-holder supports are available, offering the advantage that they can be wired in the workshop and then taken to the installation site, where they are secured to the metal back already installed in the wall,

making the whole installation process much simpler and quicker for the installer. Irrespective of the MyHOME FLATWALL solution chosen, the front cover panels are always secured to the device-holder supports with screws.

Therefore, when assembling MyHOME FLATWALL, it is always necessary to install the device-holder supports across the whole height of the unit.

# The devices-holder supports

## 72 MODULES

- Height: 60 cm
- Max. capacity: 72 DIN modules
- DIN rails and side trunkings for wiring\*
- To be used in switchboard and electric distribution board solutions.

**Note:** DIN rails and PVC trunkings are fixed and **cannot be removed**.



3789

## 36 MODULES

- Height: 30 cm
- Max. capacity: 36 DIN modules
- DIN rails and side trunkings for wiring\*
- Holes for fixing the cables with clamps
- Holes for brackets for the installation of non modular GSM burglar-alarm and temperature control units
- To be used in switchboard and electric distribution board solutions.
- Required for the installation of the multimedia box.

**Note:** DIN rails and PVC channels **can be removed**, providing maximum configuration flexibility

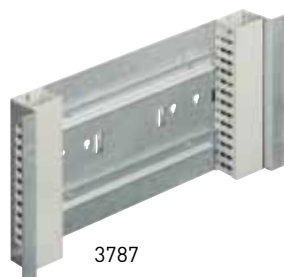

3787

## CABLE FIXING

- Height: 30 cm
- Holes for fixing the cables with clamps
- Holes for the installation of the vertical partition (3804)
- It can be equipped with DIN kit and trunkings (3790)
- To be always used in the floor riser type solution or as universal plate for free installation in other configurations



3788

\* Side trunkings for wiring, sizes 60 x 60 mm, subject to CEI-64-8 Standard for compliance with a 50% fill factor.

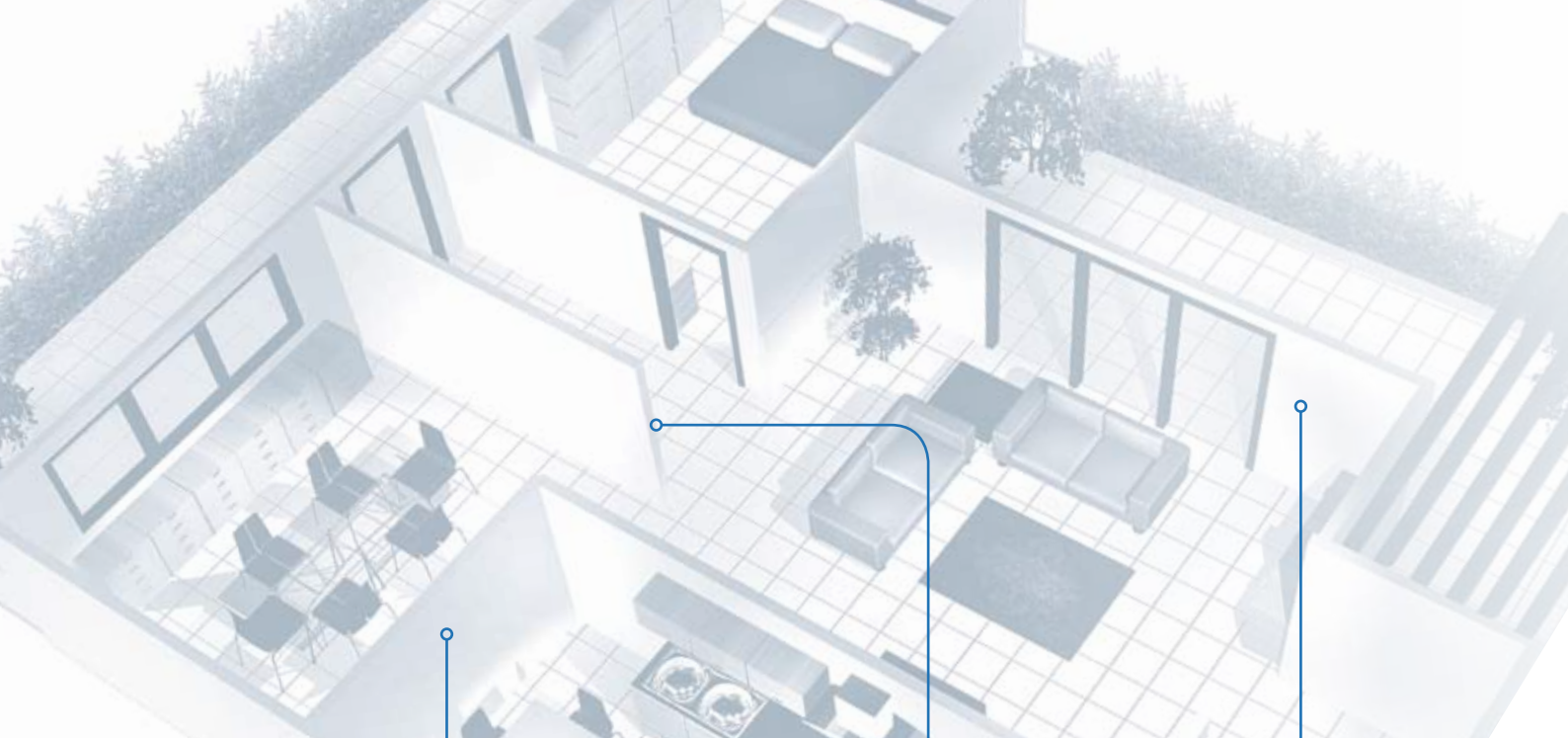

**PARTITION WALLS**

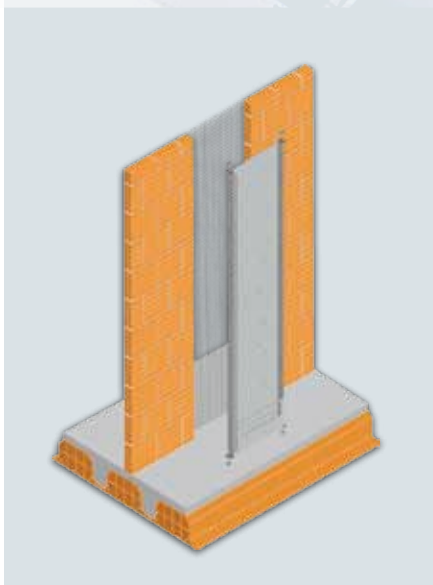

**PLASTERBOARD WALLS**

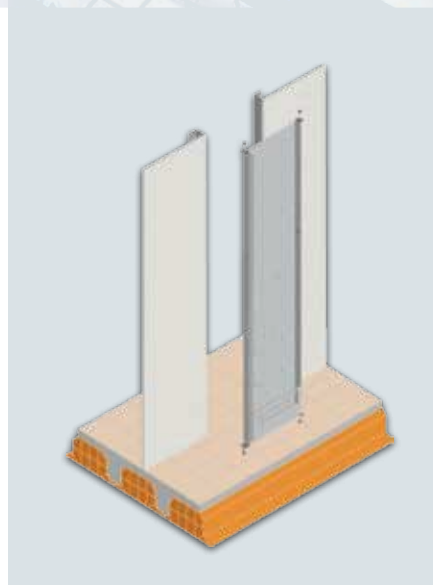

**SUPPORTING WALLS**

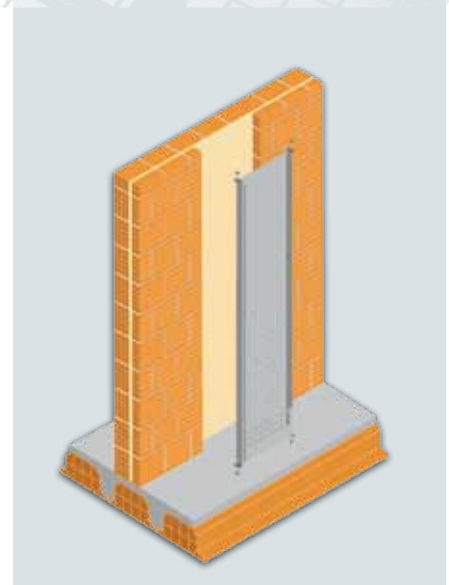

**NOTE:** for installation inside supporting walls, a 60 cm wide recess must be obtained in the wall from the floor to the ceiling. For partition or plasterboard walls leave an opening of approximately 60 cm during the construction of the wall.

# Installation solutions

The small thickness of the flush mounted back, only 8.5 cm, makes MyHOME FLATWALL suitable for installation using the same procedure as for sliding doors.

When installed while the wall is being built, the metal back also ensure savings in building materials.

The device-holder supports can be assembled at the workshop and then installed inside the metal back already fitted in the wall.

In order to preserve integrity, the finishing elements can be installed after the completion of masonry operations.

The page on the side shows a typical installation in a masonry wall.

Area for accessible and visible devices operated by the end user

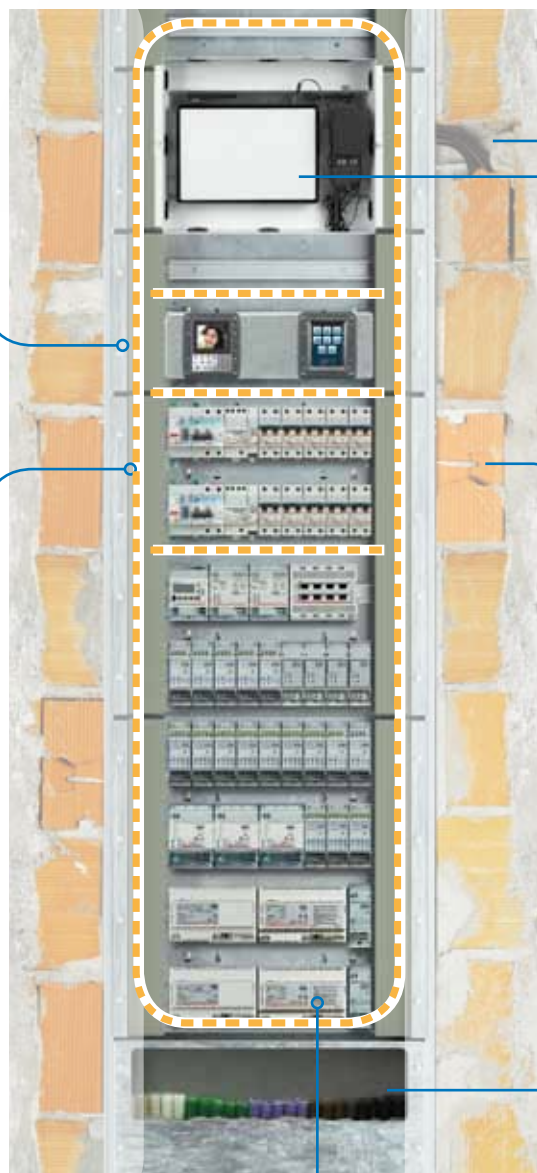

Area intended for protection devices (stop&go, thermal magnetic devices etc.)

Area for MyHOME devices

\* The FLATWALL metal structure screens the Wi-Fi signal. Therefore, the installation of an external antenna must be allowed for at the design stage.



**Side entry for corrugated ducts**



**Dedicated box for the installation of multimedia devices** (routers, modems, etc.). The metal basket, which can only be fitted on 36 module device holder supports, has cut-out marks on all sides, providing flexibility during the management of the cable passage areas. Supplied as standard are 4 rubber cable glands, required for ensuring the protection of data and power cables. For multimedia device installations requiring a large number of cables, a specific kit with 8 cable glands is also available (3831). The installation of the devices is completed using appropriate clips (F496/MF). \*



**Wall fixing bracket**



**Duct fastener plate**  
In order to facilitate the entry of cables, MyHOME FLATWALL (for the 240-270 h version) has been designed to allow the entry of several corrugated ducts, both through the bottom section, where they can be easily secured thanks to the duct fastener plate, and from the sides, through knockout holes. This operation is not required for the FLATWALL h150 version.

# MyHOME FLATWALL 240 - 270

## Assembly guide: switchboard solution

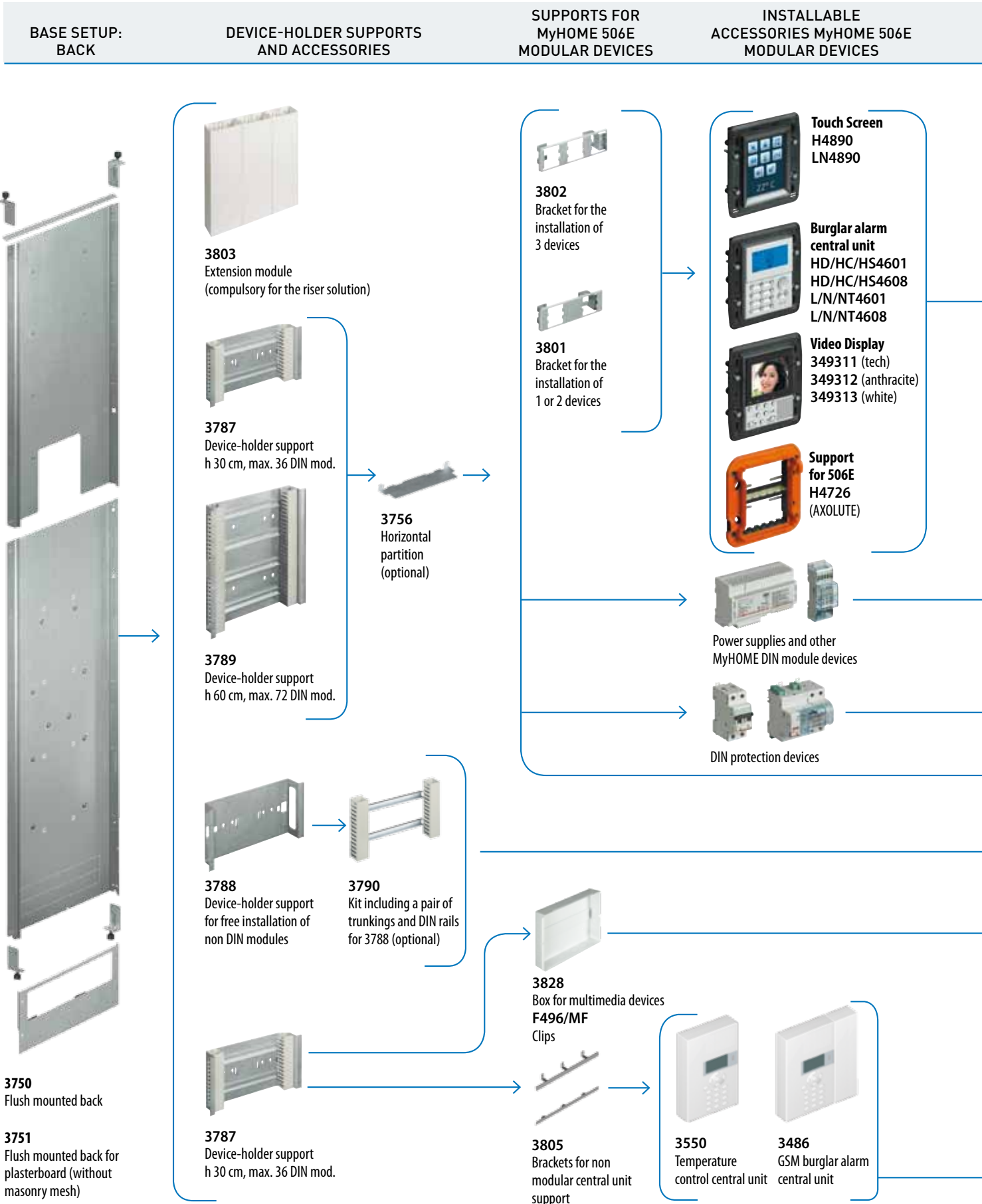

FINISHING ELEMENTS: PANELS FOR 506E MODULAR DEVICES, END CAPS AND SURROUND PLATES \*\*\*

FINISHING ELEMENTS: SIDE SURROUND PLATES



**3794N**  
Front cover panel  
h 120 cm for one device



**3795N**  
Front cover panel  
h 120 cm for two devices



**3796N**  
Front cover panel  
h 120 cm for three devices



**3817N**  
Surround plates  
for AXOLUTE items



**3791N**  
Front cover panel  
h 30 cm for one device



**3792N**  
Front cover panel  
h 30 cm for two devices



**3793N**  
Front cover panel  
h 30 cm for three devices



**3818N**  
Surround plates  
for LIVING items



**3797\*\***  
DIN switchboard  
h 30 cm, glass



**3798\*\***  
DIN switchboard  
h 30 cm, metal sheet



**3799\*\***  
DIN switchboard  
h 30 cm, plastic



**3829**  
Multimedia  
box panel  
h 30 cm



**3757**  
Front cover panel  
h 30 cm



**3759**  
Front cover panel  
h 60 cm



**3785**  
Front cover panel  
h 90 cm

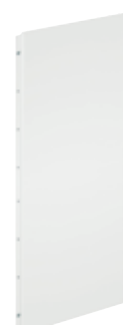

**3786**  
Front cover panel  
h 120 cm



**3771**  
Upper and lower end caps  
(to be fitted last)



**3761**  
Front cover panel for non  
modular central units\*



**3821**  
**3822**  
Side surround  
plates h 270 cm  
and h 240 cm

\* Use white blanking modules, 16133, to close any free compartments  
\*\* Use white blanking modules, E215FP1N, to close any internal free compartments  
\*\*\* Panels and upper and lower end caps must always be installed after the side surround plates (3821 or 3822)

# MyHOME FLATWALL 150

## Assembly guide: switchboard solution

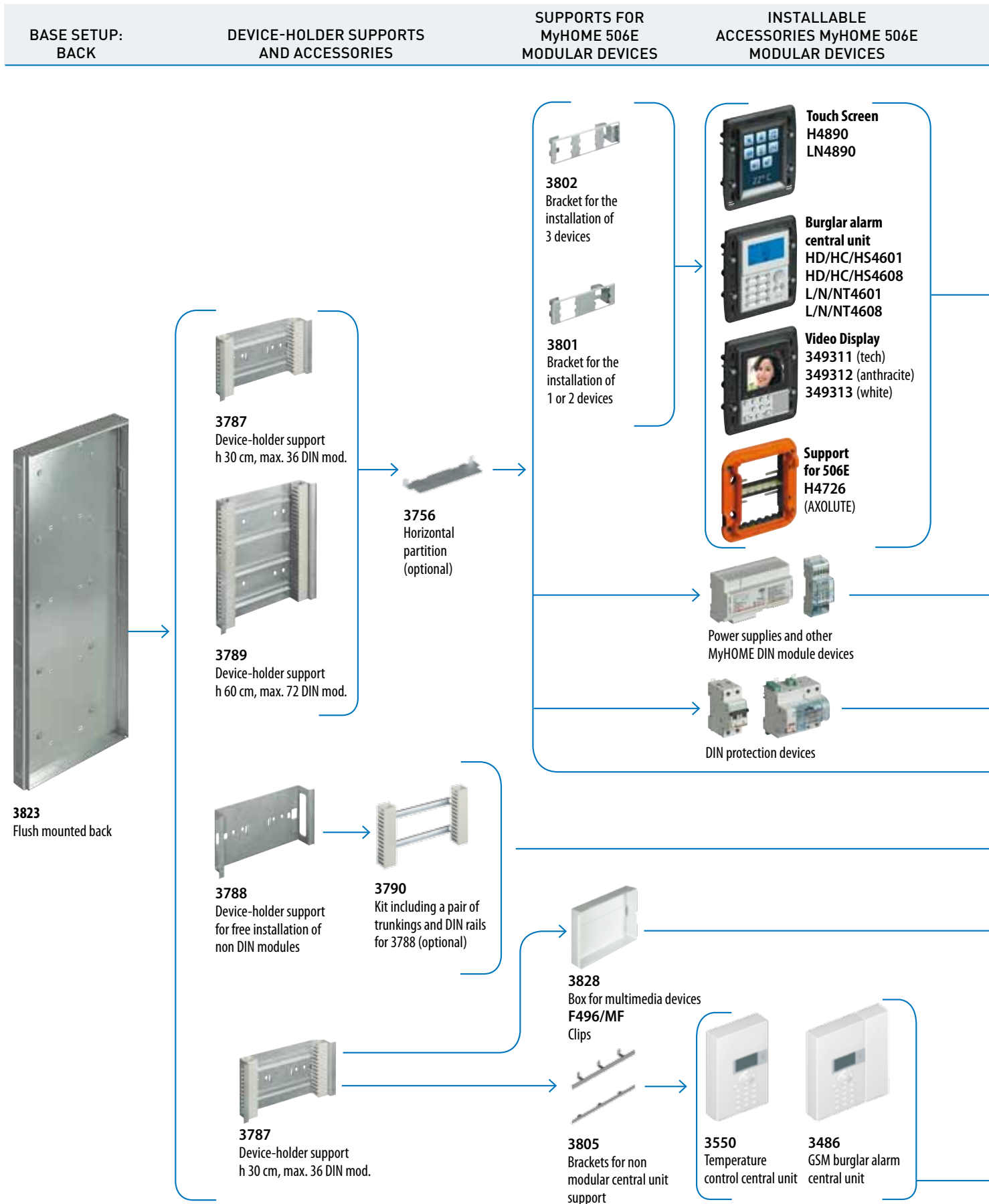

FINISHING ELEMENTS: PANELS FOR 506E MODULAR DEVICES, END CAPS AND SURROUND PLATES \*\*\*

FINISHING ELEMENTS: SIDE SURROUND PLATES



**3791N**  
Front cover panel  
h 30 cm for one device



**3792N**  
Front cover panel  
h 30 cm for two devices



**3793N**  
Front cover panel  
h 30 cm for three devices



**3817N**  
Surround plates  
for AXOLUTE items



**3818N**  
Surround plates  
for LIVING items



**3797\*\***  
DIN switchboard  
h 30 cm, glass



**3798\*\***  
DIN switchboard  
h 30 cm, metal sheet



**3799\*\***  
DIN switchboard  
h 30 cm, plastic



**3829**  
Multimedia  
box panel  
h 30 cm



**3757**  
Front cover panel  
h 30 cm



**3759**  
Front cover panel  
h 60 cm



**3785**  
Front cover panel  
h 90 cm



**3825**  
Upper and lower end caps  
(to be fitted before the  
front cover panels)



**3761**  
Front cover panel for non  
modular central units\*

\* Use white blanking modules 16133, to close any free compartments

\*\* Use white blanking modules F215FP, to close any internal free compartments

\*\*\* Panels and upper and lower end caps must always be installed after the side surround plates (3821 or 3822).



**3826**  
Side surround  
plates h 150 cm

# MyHOME FLATWALL 240 - 270

## Assembly guide: electric distribution board solution

BASE SETUP: BACK	DEVICE-HOLDER SUPPORTS AND ACCESSORIES	SUPPORTS FOR MyHOME DEVICES	INSTALLABLE DEVICES
---------------------	---	-----------------------------------	------------------------



**3750**  
Flush mounting back

**3751**  
Flush mounting back for plasterboard  
(without masonry mesh)



**3803**  
Extension module  
(compulsory for  
the riser solution)



**3787**  
Device-holder support  
h 30 cm, max. 36 DIN mod.



**3789**  
Device-holder support  
h 60 cm, max. DIN 72 mod.



**3788**  
Device-holder support for  
free installation of non  
DIN modules



**3790**  
Kit including a pair of  
trunkings and DIN rails for  
3778 (optional)



**3756**  
Horizontal  
partition  
(optional)



Power supplies and other  
MyHOME DIN module devices





**3759**  
Front cover panel  
h 60 cm



**3785**  
Front cover panel  
h 90 cm

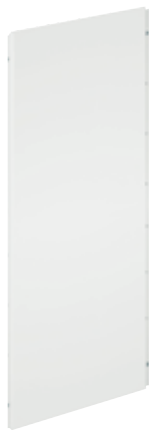

**3786**  
Front cover panel  
h 120 cm



**3771**  
Upper and lower end caps  
(to be fitted last)

\*\*\* Panels and upper and lower end caps must always be installed after the side surround plates (3821 or 3822)



**3821**  
**3822**  
Side surround plates  
h 270 cm and h 240 cm

# MyHOME FLATWALL 150

## Assembly guide: electric distribution board solution

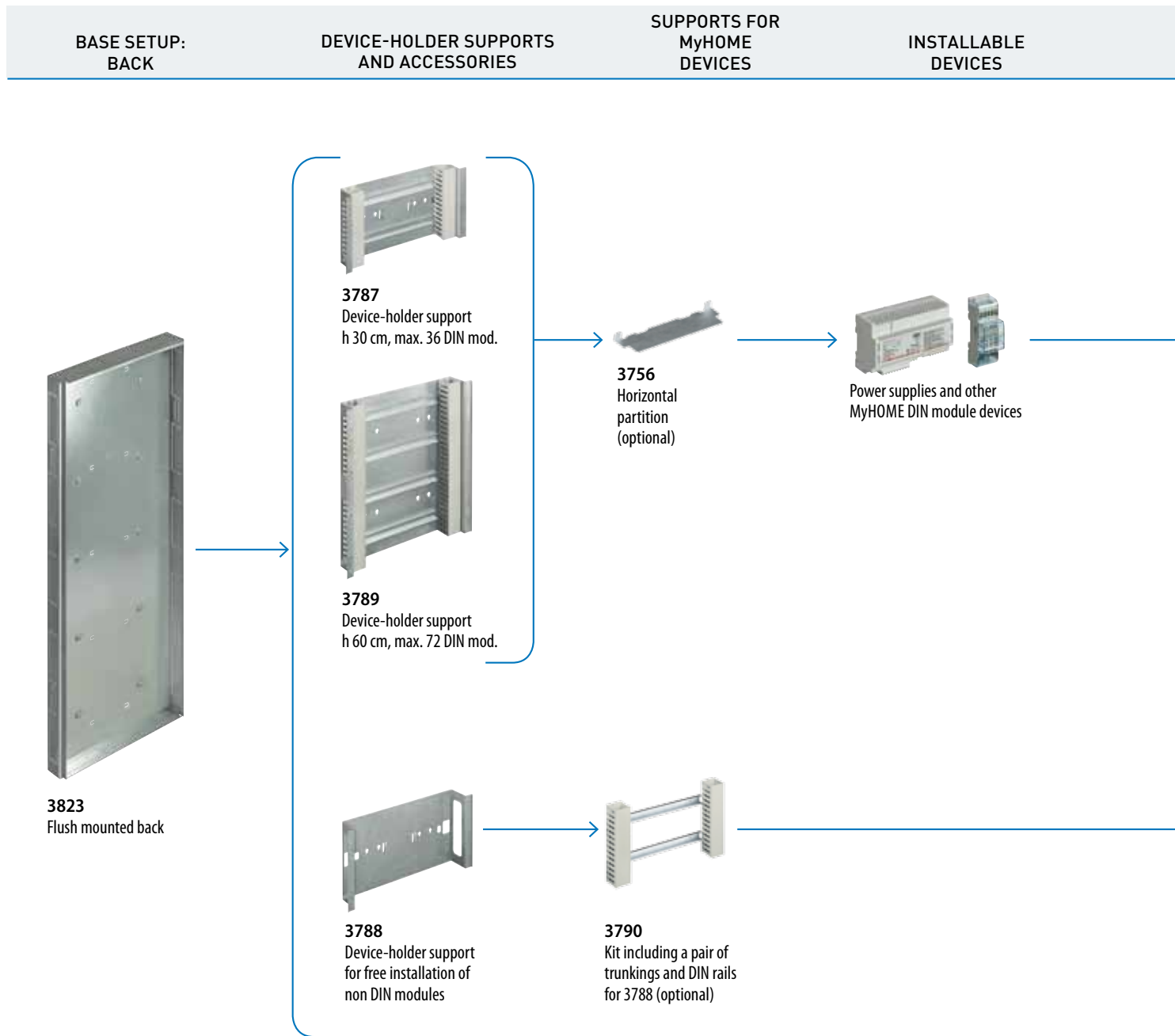

## FINISHING ELEMENTS: PANELS, END CAPS AND SURROUND PLATES \*\*\*

FINISHING ELEMENTS:  
SIDE SURROUND PLATES

**3759**  
Front cover panel  
h 60 cm



**3785**  
Front cover panel  
h 90 cm



**3825**  
Upper and lower end caps  
(to be fitted before the front cover panels)

\*\*\* Panels and upper and lower end caps must always be installed after the side surround plates (3821 or 3822).



**3826**  
Side surround plates  
h 150 cm

# MyHOME FLATWALL 240 - 270

## Assembly guide: floor riser solution

BASE SETUP:  
BACK

BRACKETS AND ACCESSORIES



**3750**  
Flush mounting back

**3751**  
Flush mounting back for plasterboard  
(without masonry mesh)



**3803**  
Extension module  
(compulsory for  
the riser solution)



**3788**  
Device-holder support for  
cable fixing



**3790**  
Kit including a pair of trunkings  
and DIN rails for 3778 (optional)



**3804**  
Vertical  
partition  
h 300 cm

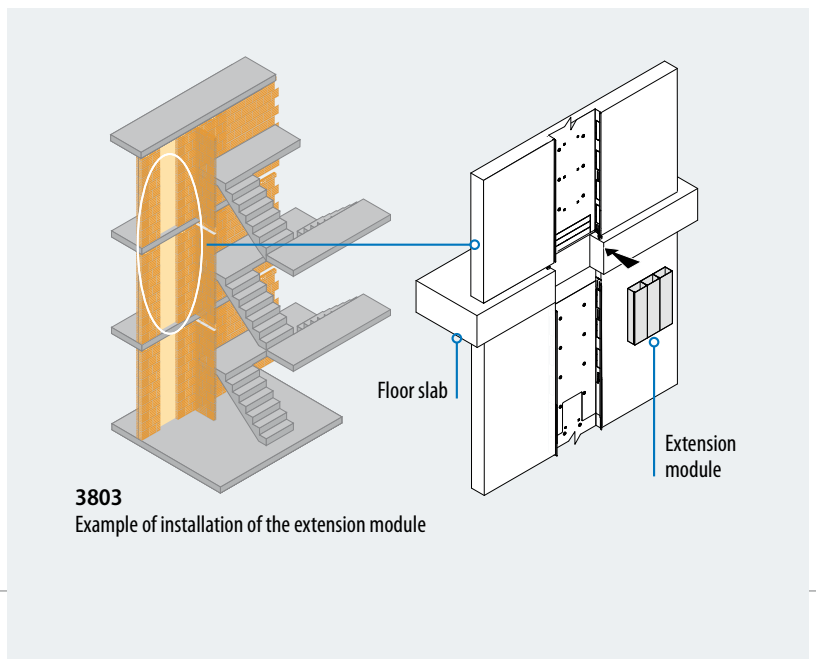

**3803**  
Example of installation of the extension module

FINISHING ELEMENTS: PANELS AND END CAPS \*\*\*

FINISHING ELEMENTS:  
SIDE SURROUND PLATES



**3759**  
Front cover panel  
h 60 cm



**3785**  
Front cover panel  
h 90 cm



**3786**  
Front cover panel  
h 120 cm



**3771**  
Upper and lower  
end caps  
(to be fitted last)

\*\*\* Panels and upper and lower end caps  
must always be installed after the side  
surround plates (3821 or 3822)



**3821**  
**3822**  
Side surround plates  
h 270 cm and h 240 cm

# EXAMPLES OF COMPOSITION

Composition with switchboard for protection devices h 270 cm

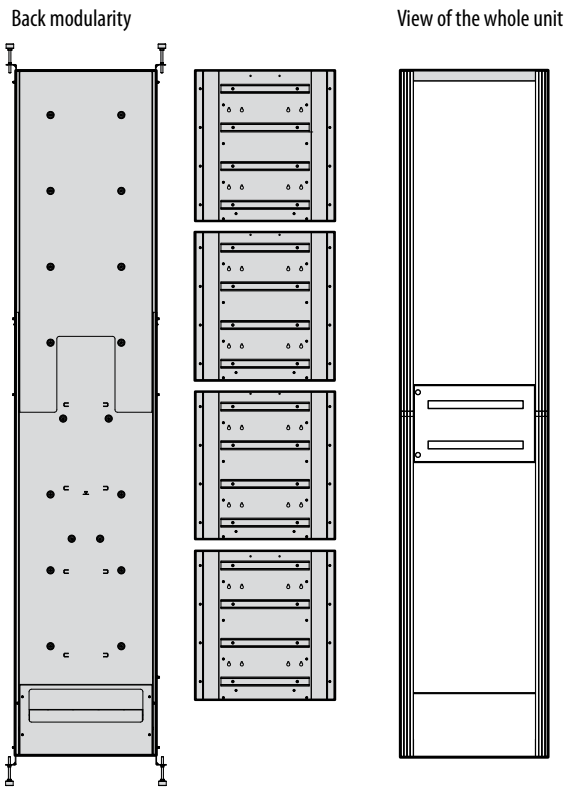

Composition with switchboard for protection devices h 240 cm

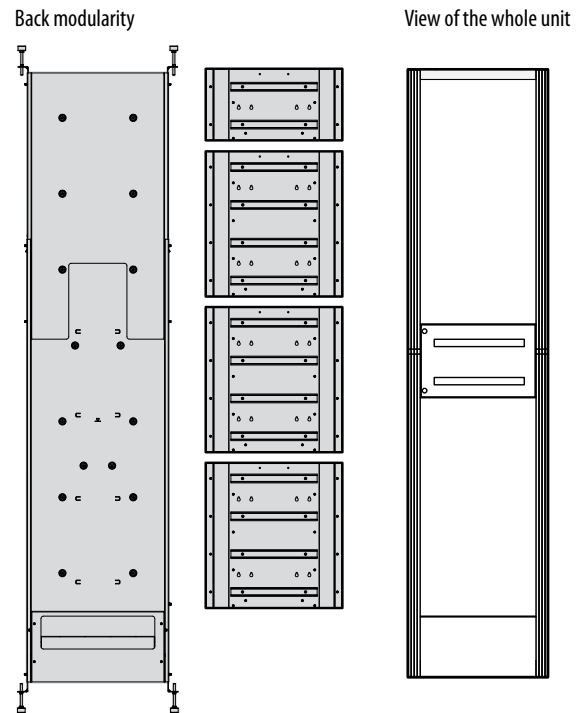

Item	MATERIAL LIST	Quantity
3750	Flush mounting back	1
3789	Device-holder support h 60 cm	4
3786	Front cover panel h 120 cm	1
3785	Front cover panel h 90 cm	1
3797	DIN switchboard glass h 30 cm	1
3821	Pair of side surround plates h 270 cm	1
3771	Upper and lower end caps	1

Item	MATERIAL LIST	Quantity
3750	Flush mounting back	1
3789	Device-holder support h 60 cm	3
3787	Device-holder support h 30 cm	1
3785	Front cover panel h 90 cm	2
3797	DIN switchboard metal sheet h 30 cm	1
3822	Pair of side surround plates h 240 cm	1
3771	Upper and lower end caps	1

Composition with switchboard for protection devices and MyHOME devices 3 + 3 modules, h 270 cm

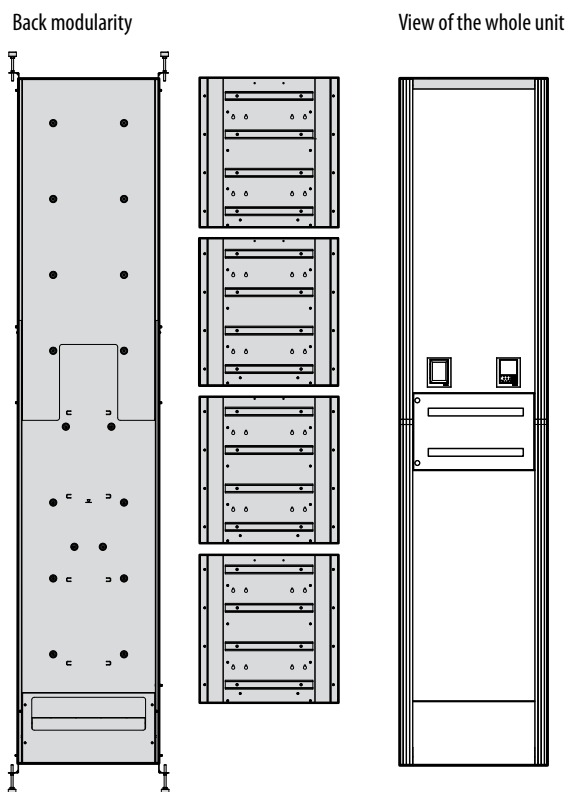

Composition with switchboard for protection devices and non modular MyHOME devices - 270 cm

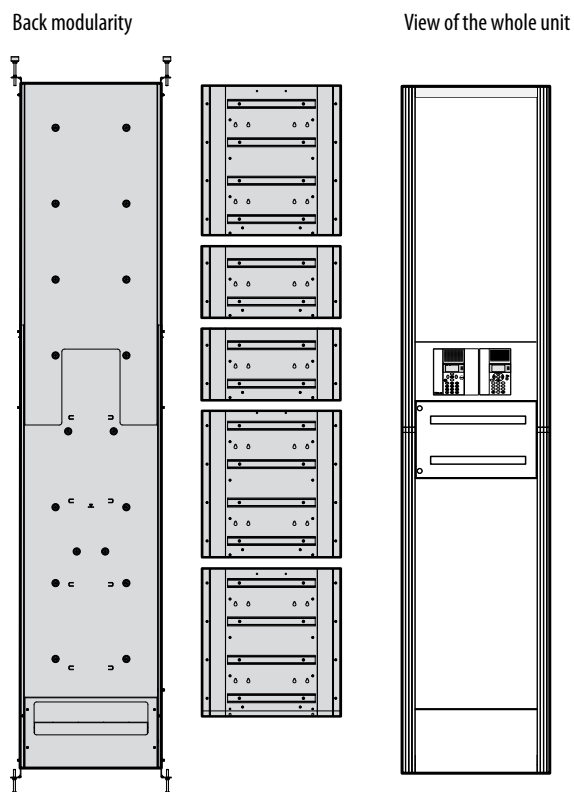

Item	MATERIAL LIST	Quantity
3750	Flush mounting back	1
3789	Device-holder support h 60 cm	4
3801	Bracket for the installation of 1 or 2 MyHOME devices	1
3785	Front cover panel h 90 cm	1
3795N	Front cover panel h 120 cm for 2 506E modular devices	1
3797	DIN switchboard glass h 30 cm	1
3821	Pair of side surround plates h 270 cm	1
3771	Upper and lower end caps	1
3817N	AXOLUTE surround plates	2

Item	MATERIAL LIST	Quantity
3750	Flush mounting back	1
3789	Device-holder support h 60 cm	3
3787	Device-holder support h 30 cm	2
3805	Brackets for non modular central unit support	1
3761	Front cover panel for non modular central units	1
3785	Front cover panel h 90 cm	2
3797	DIN switchboard glass h 30 cm	1
3821	Pair of side surround plates h 270 cm	1
3771	Upper and lower end caps	1

# EXAMPLES OF COMPOSITION

Composition for riser column h 270 cm

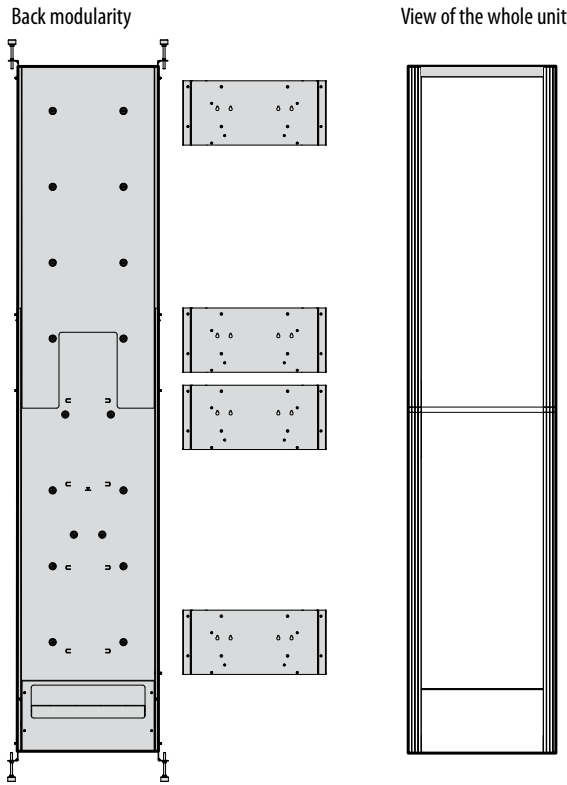

Item	MATERIAL LIST	Quantity
3750	Flush mounting back	1
3788	Device-holder support for cable fixing	4
3786	Front cover panel h 120 cm	2
3821	Pair of side surround plates h 270 cm	1
3771	Upper and lower end caps	1
3803	Extension module	1

FLATWALL h150 composition with multimedia box and MyHOME devices 3 + 3 modules

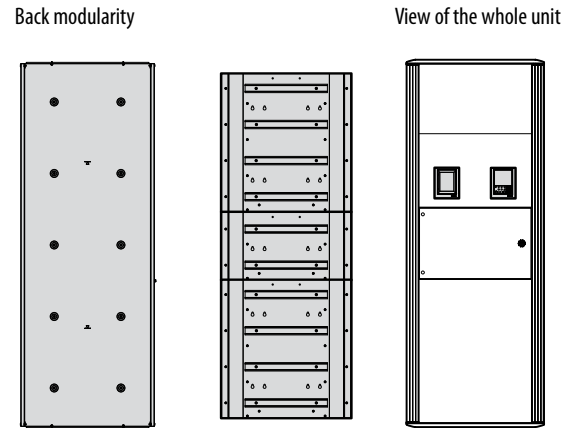

Item	MATERIAL LIST	Quantity
3823	Flush mounting back	1
3787	Device-holder support h 30 cm	1
3789	Device-holder support h 60 cm	2
3801	Bracket for the installation of 1 or 2 MyHOME devices	1
3757	Front cover panel h 30 cm	1
3792N	Front cover panel h 30 cm for 2 506E modular devices	1
3828	Multimedia box	1
3829	Front cover panel h 30 cm for Multimedia box	1
3759	Front cover panel h 60 cm	
3825	Pair of side surround plates h 150 cm	1
3826	Upper and lower end caps	1
3817N	AXOLUTE surround plates	2

**NOTE:** To ensure maximum design integration with the room where it is installed, MyHOME FLATWALL front cover panels, supplied in their original white colour, may also be painted using the same paint as the walls.



## EXAMPLES OF AESTHETIC COMPOSITIONS

GSM burglar alarm central unit 3486 and temperature control central unit 3550

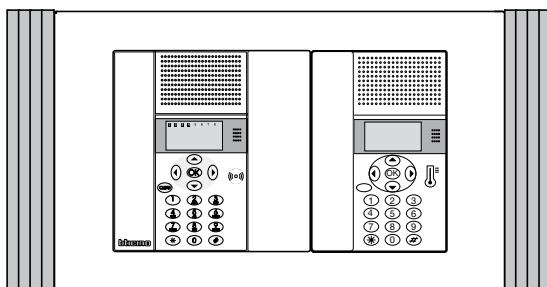

Item	MATERIAL LIST	Quantity
3805	Pair of brackets for non modular central units	1
3761	Front cover panel for non modular central units	1

Switchboard for electrical protection devices

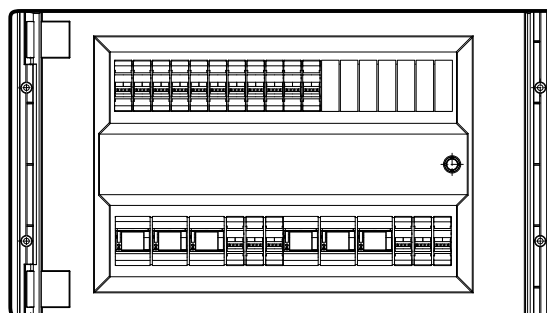

Item	MATERIAL LIST	Quantity
3797	DIN switchboard glass h 30 cm	1
F215FP	White blanking modules for closing any free compartments	***

\*\*\* Use 1 blanking module for each free DIN module

GSM burglar alarm central unit 3486

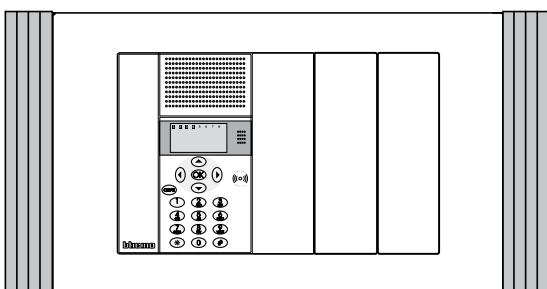

Item	MATERIAL LIST	Quantity
3805	Pair of brackets for non modular central units	1
3761	Front cover panel for non modular central units	1
16133	White blanking modules for closing a free compartment	2

Multimedia box

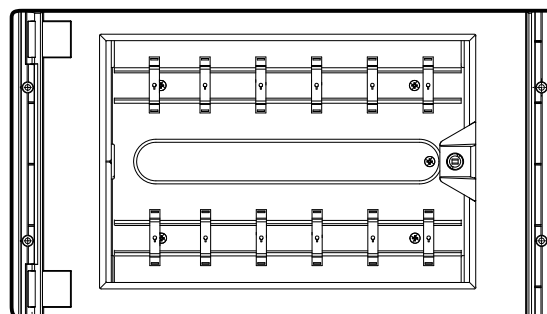

Item	MATERIAL LIST	Quantity
3828	Box for multimedia devices, with cable gland cut-outs	1
3829	Door for 30 cm high multimedia box	1
F496/MF	Clips for the installation of multimedia devices. 6 clips are already supplied as standard with the 3828 box	n*
3831	Cable gland kit for multimedia box. 4 cable glands already supplied as standard with the 3828 box	n*

\* Depending on installation requirements

MyHOME, Touch Screen, Video Display, etc. devices

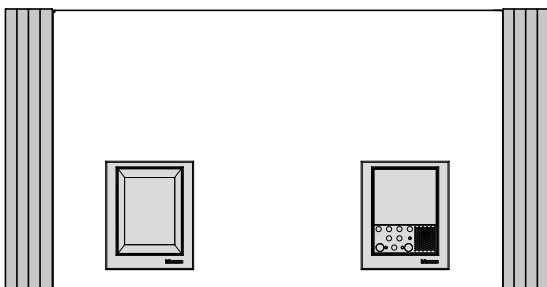

Item	MATERIAL LIST	Quantity
3801	Bracket for the installation of 1 or 2 506E devices	1
3792N	Front cover panel for 2 MyHOME devices	1
3817N	Surround plates for AXOLUTE items	2

# HOW TO INSTALL MyHOME FLATWALL

## CORRECT POSITIONING AND FIXING OF CORRUGATED DUCTS

For correct installation, one must comply with only two requirements.

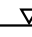
The  index on the flush mounting back must be aligned with the meter height mark on the installation site; this requirement is automatically complied with if the unit is installed inside plasterboard walls after the floor has been finished.

To ensure correct installation, the wall finish must be flush with the front profile of the FLATWALL back as shown in enlargement A.

Only for FLATWALL 240 - 270: After installing the duct fastener plate and completing the installation of the corrugated ducts, seal with cement or resin (for installation inside plasterboard walls), as shown in the following figures.

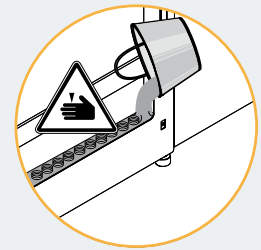
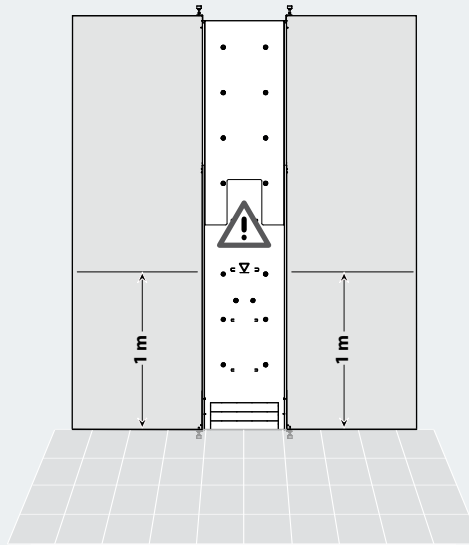
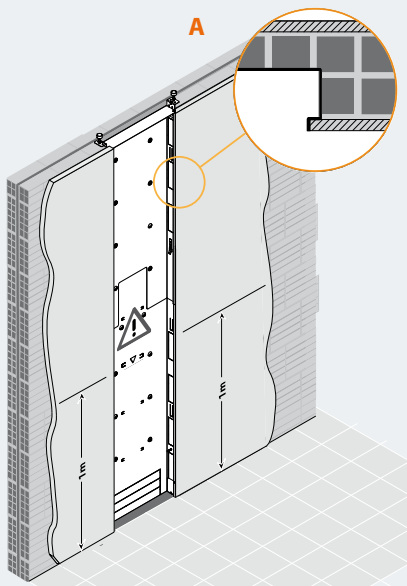

Installation inside masonry walls: cement

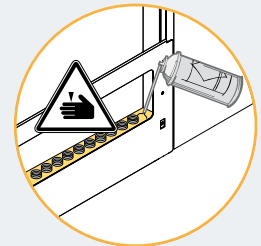

Installation inside plasterboard walls: resin

## PREASSEMBLY OF DEVICES AT THE WORKSHOP

The installer can pre-assemble the devices on the device-holder supports at their workshop, pre-wiring and configuring them at the same time. The preassembled unit can then be transported to the site for installation inside MyHOME FLATWALL.

This solution brings important time savings during on site installation. The 60x60 mm wiring trunkings are in accordance with CEI 64-8 standard for compliance with a 50% fill factor.

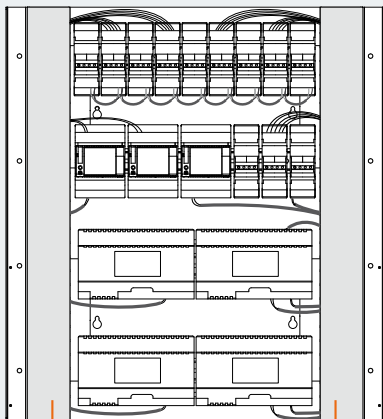

60x60 mm wiring trunkings

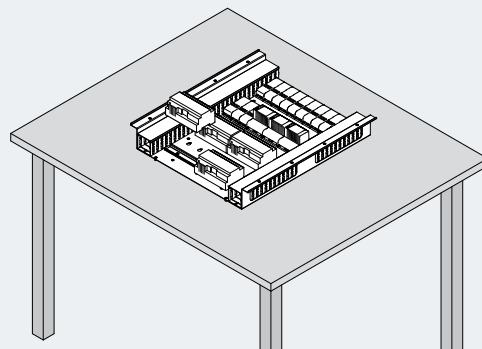

### POSITIONING OF DEVICES INSIDE FLATWALL

Due to the fact that the devices being installed inside MyHOME FLATWALL generate heat, tests have been carried out to identify the best positioning in order to obtain correct dissipation. It is therefore recommended

that the products are distributed as shown in the drawing below, with the items emitting the most heat at the bottom and those emitting the least at the top of the unit. See the table below for the thermal dissipation values.

MyHOME FLATWALL THERMAL DISSIPATION	H 270 cm	H 240 cm
Installation in masonry and brick walls	800 W	700 W
Installation in plasterboard walls	700W	600 W

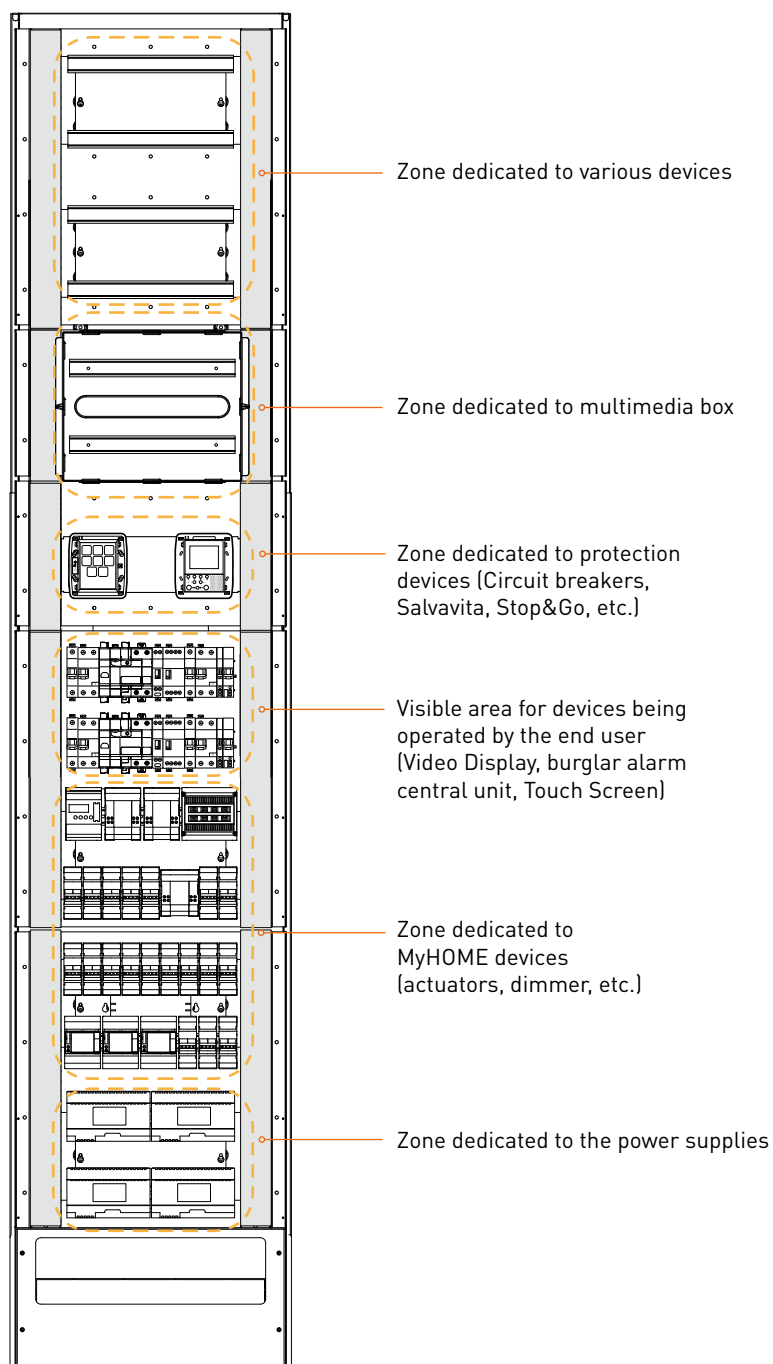

# BASE, DEVICE-HOLDER SUPPORTS AND ACCESSORIES

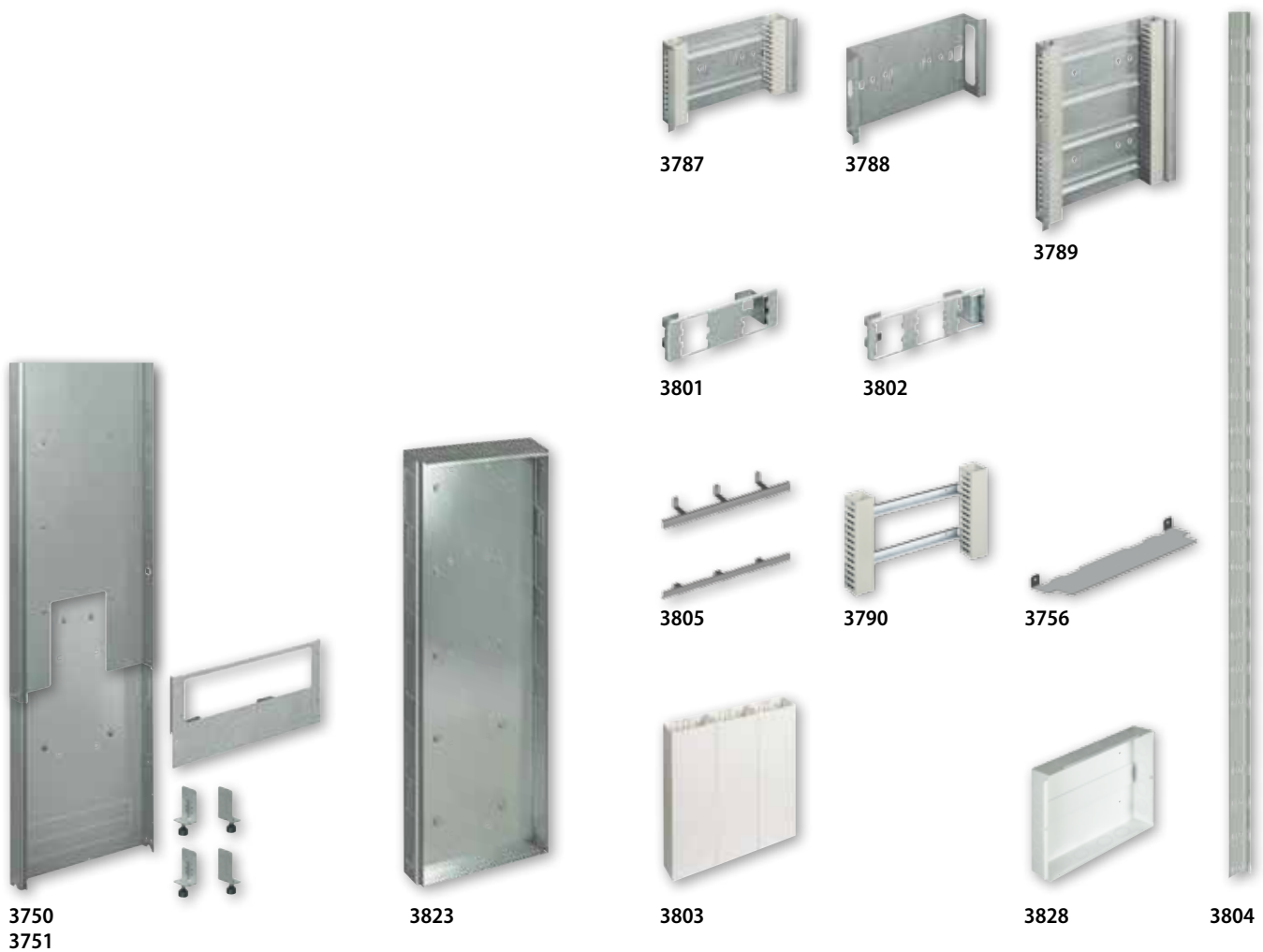

Item	WALL BASE MODULE
3750	base module h 240 - 270 cm for masonry walls consisting of: lower module back, telescopic module back, upper end cap, bracket with adjustable feet, duct fastener plate and masonry mesh
3751	module as above, for plasterboard walls
3823	flush-mounting module h 150 cm for masonry and plasterboard walls

Item	DEVICE-HOLDER SUPPORTS AND ACCESSORIES
3787	device-holder support h30 cm, max. 36 DIN mod.
3788	device-holder support for free fixing of non DIN devices, or for fixing cables when used as a riser
3789	device-holder support h60 cm, max. 72 DIN mod.
3801	bracket for the installation of 1 or 2 MyHOME 506E modular devices
3802	bracket for the installation of 3 MyHOME 506E modular devices
3805	pair of brackets for non modular central units
3790	kit including a pair of trunkings and DIN rails for 3788
3756	horizontal partition (optional)
3803	extension module. To be used as joining piece when crossing floors. Its use is compulsory in the riser solution
3804	vertical partition h 300 cm to separate cables in the riser solution
3828	multimedia box to be completed with F496/MF clips
3831	cable gland kit for multimedia box

## FINISHING ELEMENTS

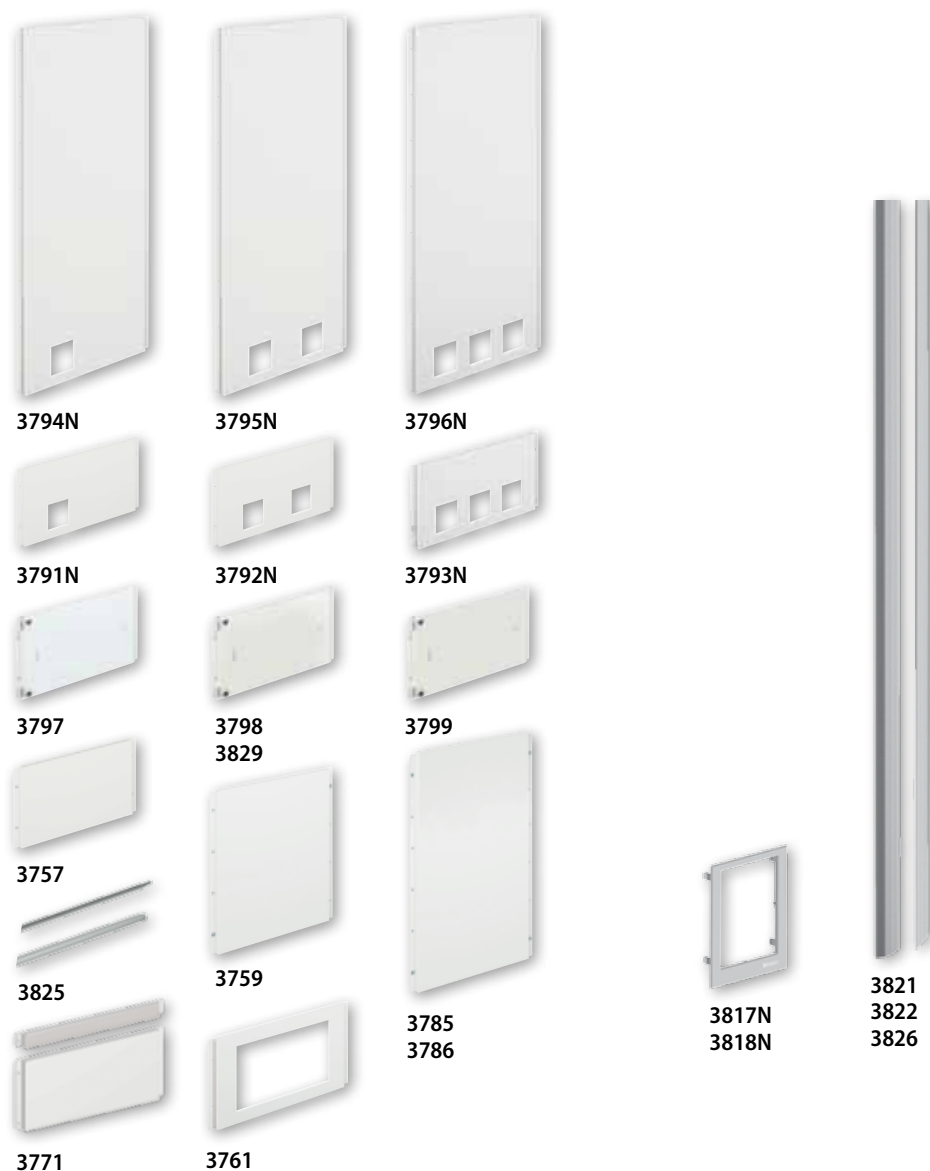

Item	PANELS
<b>3794N</b>	front cover panel h 120 cm for 1 506E modular device
<b>3795N</b>	front cover panel h 120 cm for 2 506E modular devices
<b>3796N</b>	front cover panel h 120 cm for 3 506E modular devices
<b>3791N</b>	front cover panel h 30 cm for 1 506E modular device
<b>3792N</b>	front cover panel h 30 cm for 2 506E modular devices
<b>3793N</b>	front cover panel h 30 cm for 3 506E modular devices
<b>3797*</b>	glass DIN switchboard h 30 cm
<b>3798*</b>	metal sheet DIN switchboard h 30 cm
<b>3829</b>	multimedia box panel h 30 cm
<b>3799*</b>	plastic DIN switchboard h 30 cm
<b>3757</b>	front cover panel h 30 cm
<b>3759</b>	front cover panel h 60 cm
<b>3785</b>	front cover panel h 90 cm
<b>3786</b>	front cover panel h 120 cm
<b>3771</b>	upper and lower end caps for 240 and 270 versions
<b>3825</b>	upper and lower end caps for 150 version
<b>3761**</b>	front cover panel for non modular central units

\* Use white blanking modules, F215FP, to close any free compartments  
 \*\* Use white blanking modules, 16133, to close any free compartments

Item	SURROUND PLATES AND PROFILES
<b>3817N</b>	surround plate for AXOLUTE items
<b>3818N</b>	surround plate for LIVING items
<b>3821</b>	side finishing profiles h 270 cm
<b>3822</b>	side finishing profiles h 240 cm
<b>3826</b>	side finishing profiles h 150 cm

# DIMENSIONAL DATA

## MyHOME FLATWALL 240 - 270

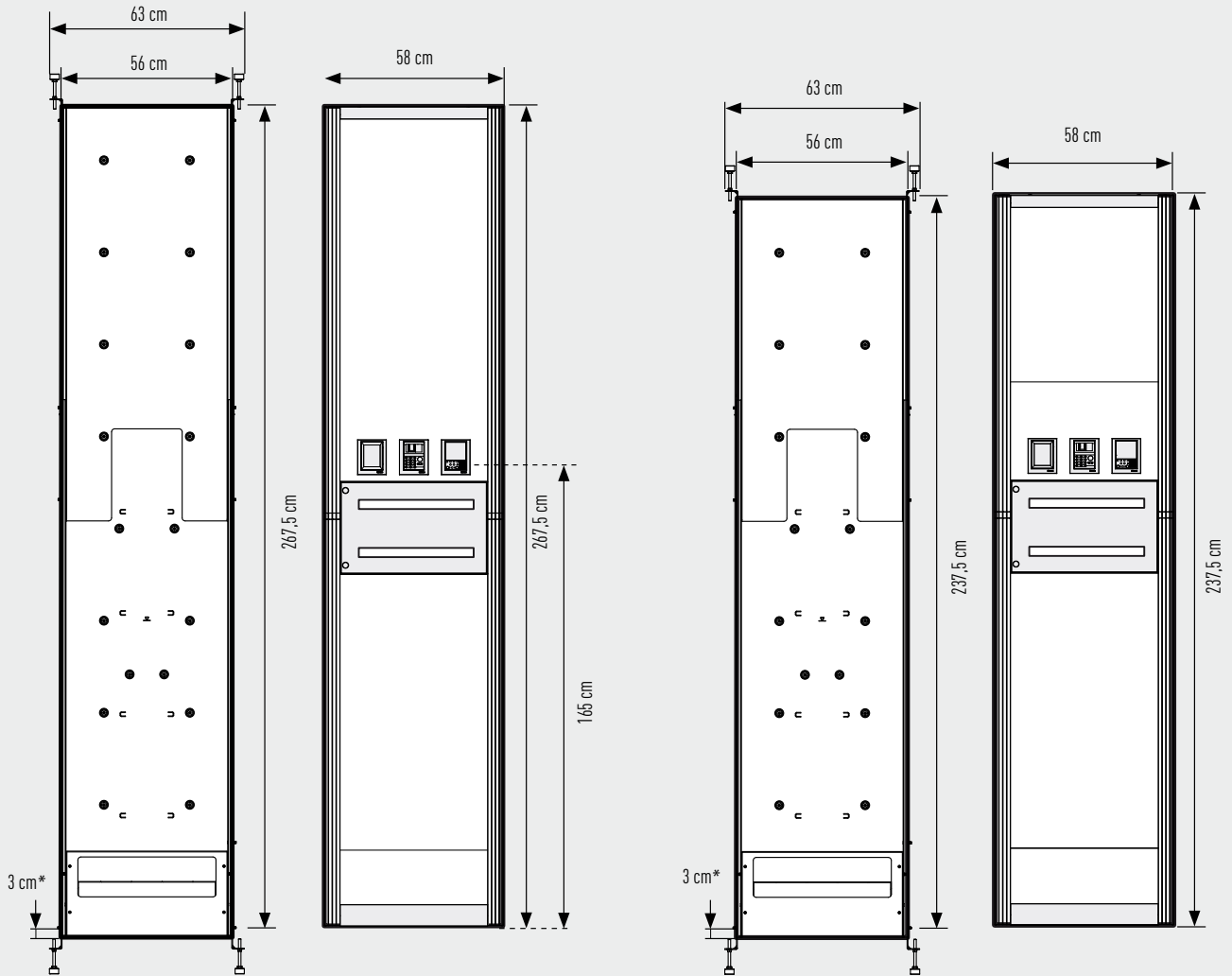

\* Back section embedded in the floor, for 3750 only (not for 3751)

## THICKNESS - VIEW FROM THE TOP WITH COMPONENTS ASSEMBLED

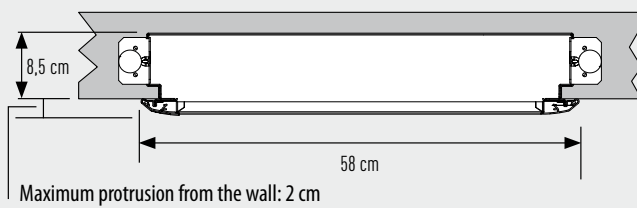

**MyHOME FLATWALL 150**

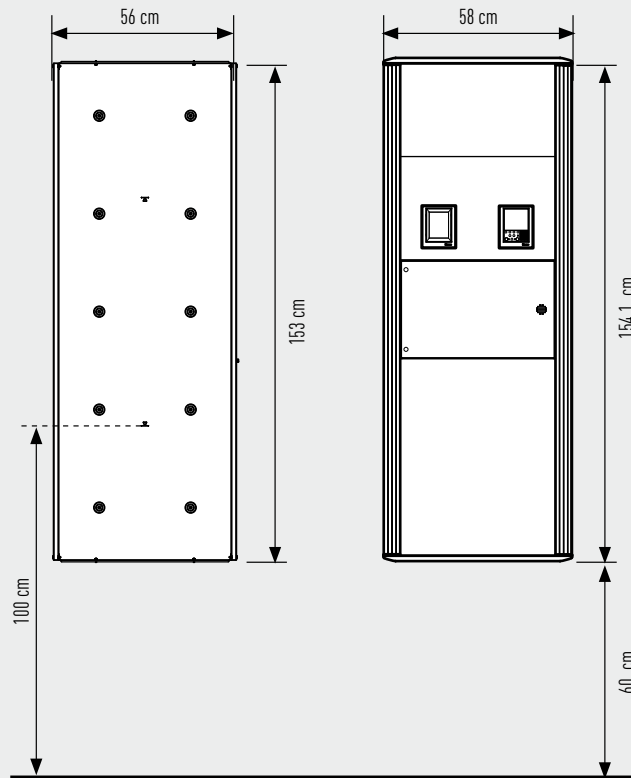

**THICKNESS - VIEW FROM THE TOP WITH COMPONENTS ASSEMBLED**

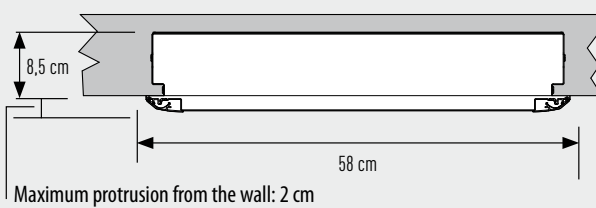

# DIMENSIONAL DATA

## PANELS, SWITCHBOARDS, UPPER AND LOWER END CAPS AND FLOOR CROSSING SECTION

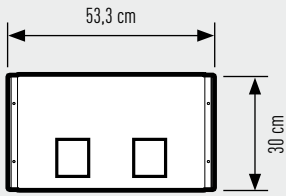

3791N, 3792N, 3793N

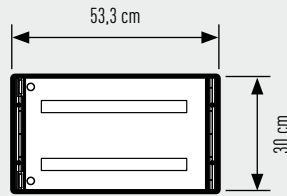

3797, 3798, 3799

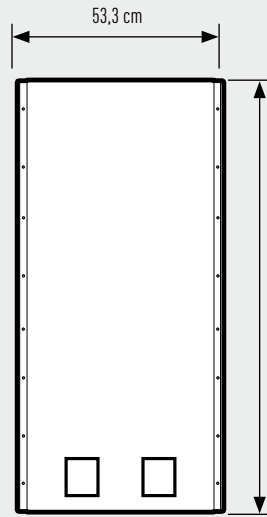

3794N, 3795N, 3796N

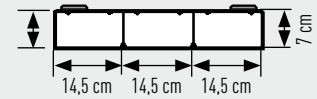

3803

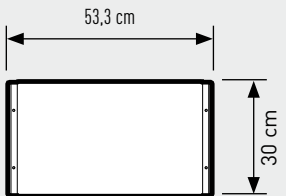

3757

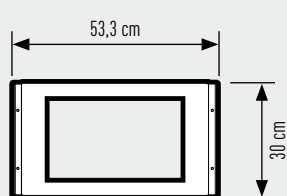

3761

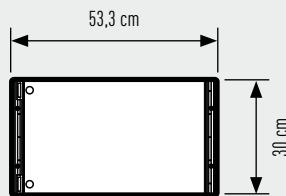
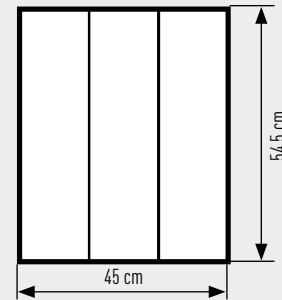

3829

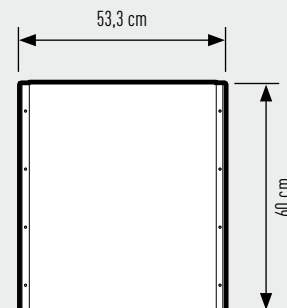

3759

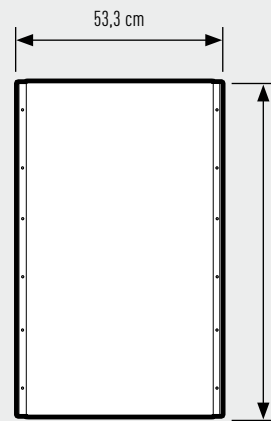

3785

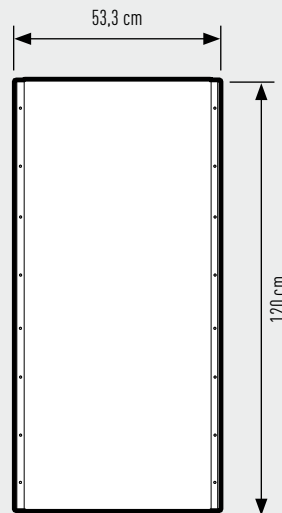

3786

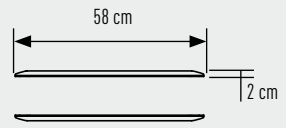

3825

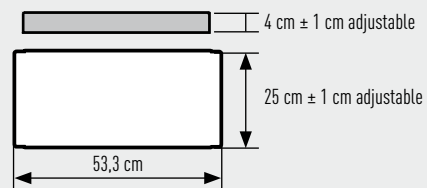

3771



**DEVICE-HOLDER SUPPORTS**

Max. 72 DIN modules split on 4 rows of 18 mod. - Max. 36 DIN modules split on 2 rows of 18 mod.

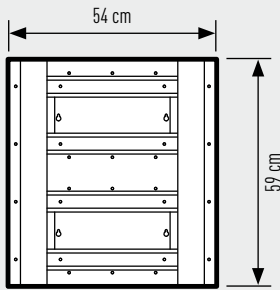

**3789**

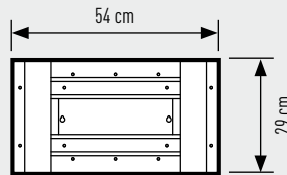

**3787**

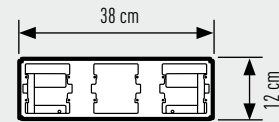

**3801 - 3802**

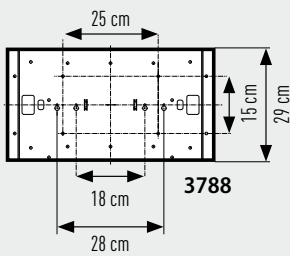

**3788**

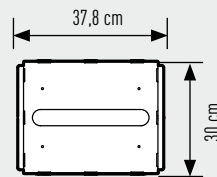

**3828**

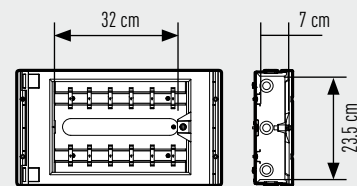

Useful space for the installation of multimedia devices

# DESIGN CUSTOMISATION

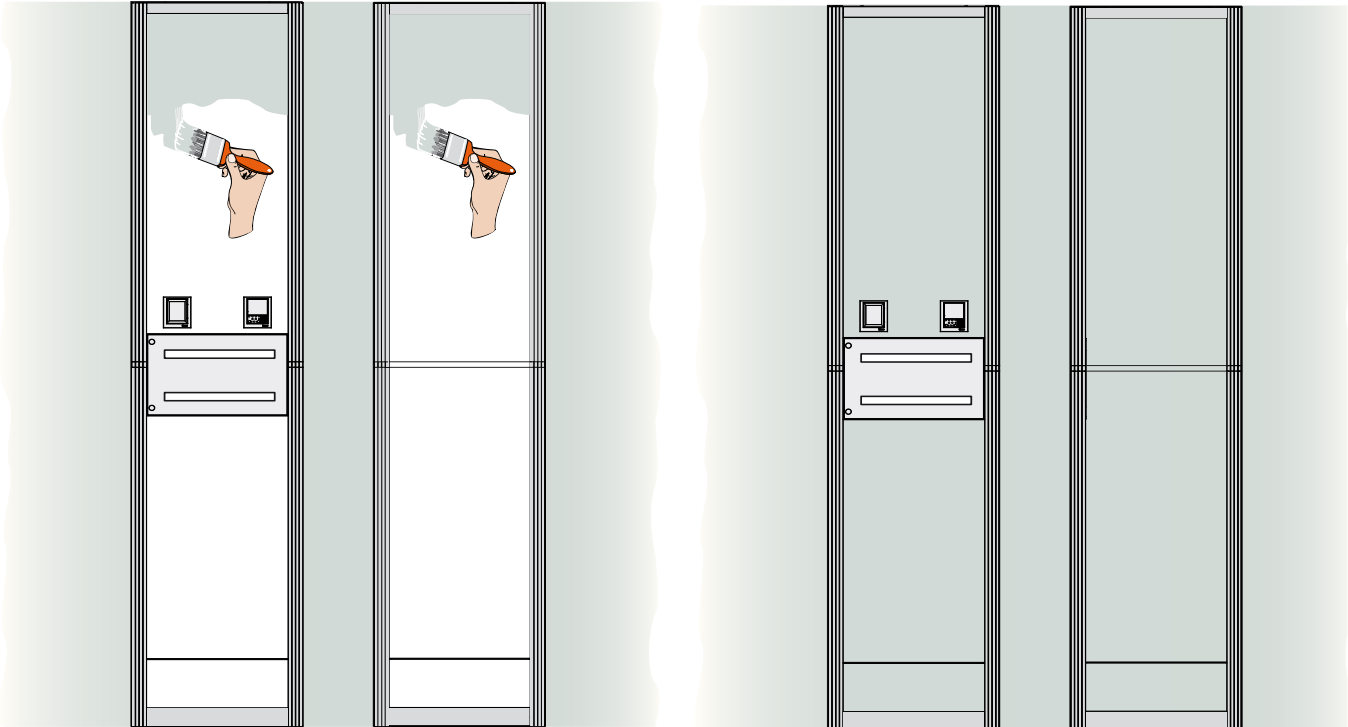



**BTicino** SpA  
Viale Borri, 231  
21100 Varese - Italy  
[www.bticino.com](http://www.bticino.com)

AD-ITMH14FWG/GB - Edition 01/2014

BTicino SpA reserves at any time the right to modify the contents of this booklet and to communicate in any form and modality, the changes brought to the same.